

## ◆ Notes

1. The button function and combination button function are effective for wireless receivers with corresponding functions.
2. To use the button function and combination button function, select the current remote control channel to transmit signal.
3. When used with different wireless receivers, the settings and using methods are a little different, see Product Instructions for getting more details.

### [Stop]+[Up/Open]

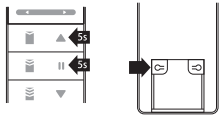

Press for 5 seconds to enter into switch on touch control function status, and then press [channel setting] to confirm it but within 5 seconds.

### [Stop]+[Down/Close]

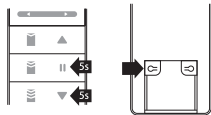

Press for 5 seconds, press [Channel setting] to confirm, switch off touch control.

## ◆ Set remote control channel

### ① Enter into setting code status



Press motor [setting code] for 3 seconds until the LED light on.

### ② Choose channel



Press [channel choose left] or [channel choose right] to choose the needed channel.

### ③ Transmit the current channel code

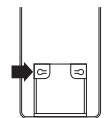

Press [channel setting] button on the back of remote with using sharp tip, the motor LED light will flash.

### ④ Confirmation



Press motor [setting code] to confirm it and finish the channel setting process.

## ◆ Delete remote control channels

### ① Enter into setting codes status

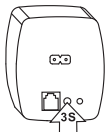

Press motor [setting code] for 3 seconds until the LED light on.

### ② Delete remote control channels



At first, release. Press motor [setting code] for 7 seconds until the LED light off and finish the clear channel process.

## Warranty

Series motor carry a three years warranty from the date of invoice. Factitious damage and dismantle are exclusive of warranty.

# YR2188B

## Wireless transmitter instruction

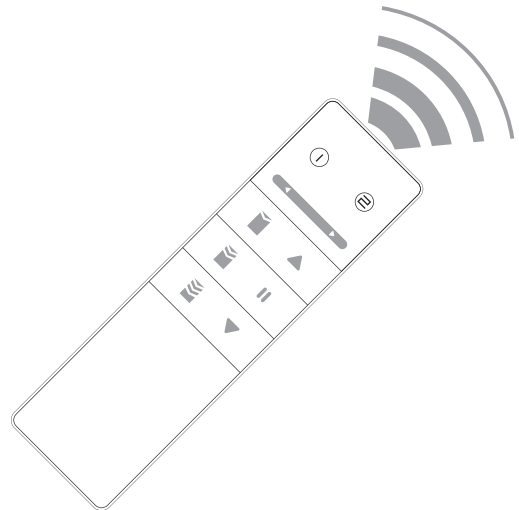

## Specification

Model	YR2188B
Frequency	433.92MHz±75KHz
Mould	ASK
Battery	CR2032X1
Channel	2

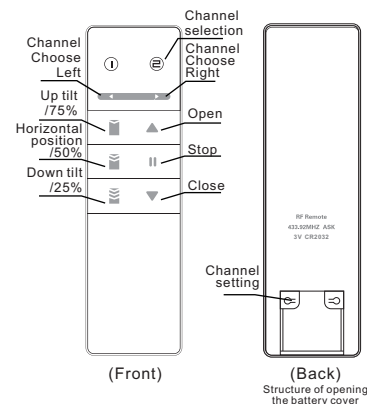

## Button function

### ① [Up/Open]



Open the curtains.

### ③ [Down/Close]

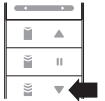

Close the curtains.

### ⑤ [Horizontal Position/50%]

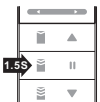

One function is tilting slat to horizontal when short press it, another function is long press for 1.5 seconds, the motor will stop when it runs to the intermediate stop point 2. Default position percentage is 50%.

### ⑦ [Channel Setting]

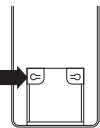

### ② [Stop]



Stop the curtains.

### ④ [Up Tilting/75%]

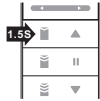

One function is up tilt slat when short press it, another function is long press for 1.5 seconds, the motor will stop when it runs to the intermediate stop point 1. Default position percentage is 75%.

### ⑥ [Down Tilting/25%]

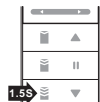

One function is down tilt slat when short press it, another function is long press for 1.5 seconds, the motor will stop when it runs to the intermediate stop point 3. Default position percentage is 25%.

Open the remote cover and then use the [channel setting] to set code. It can receive the signal and handle non-match channel setting button after remote controller or motor enter into setting code status.

## Combination button function

◆ Specific operations are as follows:

### [Channel Choose Left]+[Stop]

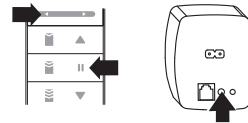

Change direction, press the motor [setting code] to confirm after remote controller or motor enter into setting code status and then match the change direction code.

### [Channel Setting]+[Stop]

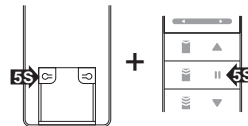

Long press it for 5 seconds, clear the limits. At first, press [channel setting] all the time and then press [stop].

### [Up/Open]+[Down/Close]

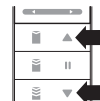

External control mode change, press the motor [setting code] to confirm after remote controller or motor enter into setting code status and then match the code.

### [Channel Setting]+[Horizontal Tilting/50%]

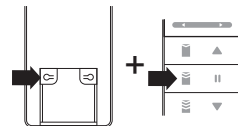

Short press it for setting intermediate position 2, if long press, it will be used for setting 50% position. At first, press [channel setting] all the time and then press [horizontal position/50%].

### [Channel Setting]+[Up/Open]

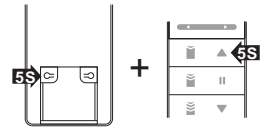

Long press it for 5 seconds to let the motor enter into up/open limit setting status. At first, press [channel setting] all the time and then press [up/open]. After motor goes to the up limit position as you like, and press motor [setting code] to confirm it.

### [Channel Setting]+[Down/Close]

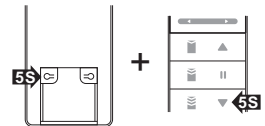

Long press it for 5 seconds to let the motor enter into down/close limit setting status. At first, press [channel setting] all the time and then press [down/close]. After motor goes to the down limit position as you like, and press motor [setting code] to confirm it.

### [Channel Setting]+[Up Tilting/75%]

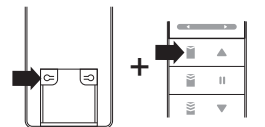

Short press it for setting intermediate position 1, if long press, it will be used for setting 75% position. At first, press [channel setting] all the time and then press [up tilt/75%].

### [Channel Setting]+[Down Tilting/25%]

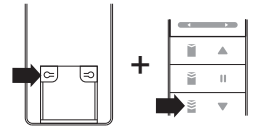

Short press it for setting intermediate position 3, if long press, it will be used for setting 25% position. At first, press [channel setting] all the time and then press [down tilt/25%].