

### Datasheet

Issued: April 7, 2019

Edition V1.0.0

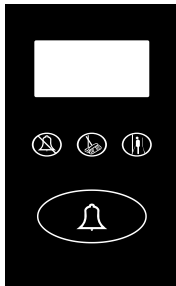

Figure 1. Intelligent Hotel Door Bell

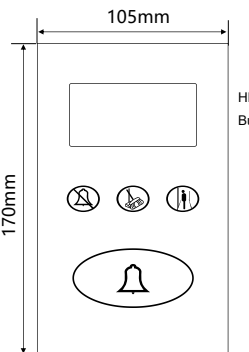

Figure 2. Dimensions - Front View

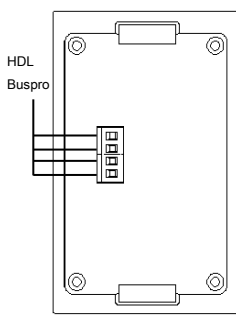

Figure 3. Wiring

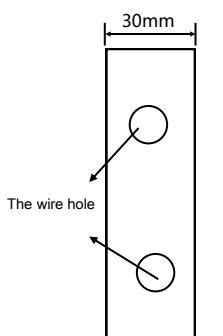

Figure 4. Wall box - Side View

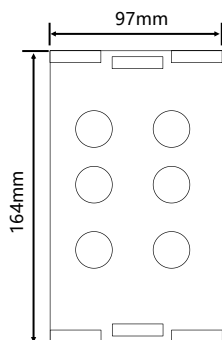

Figure 5. Wall box - Front View

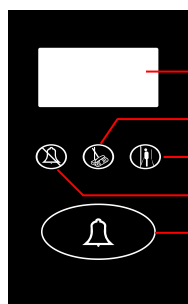
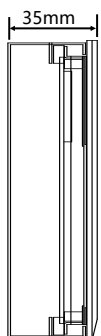

Figure 7. Front View

## Overview

Intelligent Hotel Door Bell ( See Figure 1) is a door bell touch panel which is installed outside the room by the door. Through the control panel or other devices, it can display customer's requirements, for example, Please Wait, Clean Room, or DND, etc.

## Functions

- Room number display. Information display (Please Wait, Need Cleaning, DND, etc.) in different colors.
- Door bell
- Supports HDL Buspro online update

## Important Notes

- Buspro cable - CAT5E or dedicated HDL Buspro cable.
- Buspro connection - Series connection (hand-in-hand recommended)
- Installation - Wall box installation, outside the room by the door.

## Product Information

### Dimensions and wiring - See Figure 2 - 6

#### Front view - See Figure 7

A1: Room number display, Universal switch No.4

A2: Clean Room, Universal switch No.3

A3: Please Wait, Universal switch No.1

A4: DND, Universal switch No.2

A5: Doorbell, Universal switch No.5

Note :

1. Door bell touch panel has special-designed back box, which can fix and protect the panel. Hole for wire connections are made inside the back box.

2. Other equipment can control this doorbell by universal switch. For example, set the type of button for universal switch in panel and parameter 2 is set to 2. When you control this button, the light of doorbell will turn on. The doorbell button should make the doorbell in the open state (the indicator turns on). When the state is DND, the doorbell button will disable.

#### Installation - See Figure 8 - 9

Step 1. Install the wall box in the wall.

Step 2. Complete cable connection.

Step 3. Fix the doorbell on the wall box with screws.

## Safety Precautions

- The installation and commissioning of the device must be carried out by HDL or the organization designated by HDL. For planning and construction of electric installations, the relevant guidelines, regulations and standards of the respective country are to be considered.
- The device should be installed in wall box. HDL does not take responsibility for all the consequences caused by installation and wire connection that are not in accordance with this document.
- Please do not privately disassemble the device or change components, otherwise it may cause mechanical failure, electric shock, fire or body injury.
- Please resort to our customer service department or designated agencies for maintenance service. The warranty is not applicable for the product fault caused by private disassembly.

## Package Contents

HDL-MHB.1010\*1 / Wall box\*1 (including fixing plate\*2 / screw\*2) / Datasheet\*1

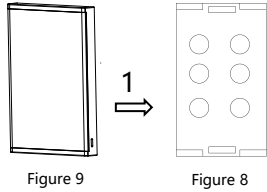

Figure 8 – 9. Installation

## Technical Data

### Basic Parameters

Working voltage	12~30V DC
Working current	45mA/24V DC
Communication	HDL Buspro

### External Environment

Working temperature	-5°C~45°C
Working relative humidity	≤90%
Storage temperature	-20°C~60°C
Storage relative humidity	≤93%

### Specifications

Dimensions	105×170×35 (mm)
Net weight	330g
Housing material	Glass
Installation	Wall box (See Figure 8 - 9)
Protection rating (Compliant with EN 60529)	IP20

### Name and Content of Hazardous Substances in Products

Components	Hazardous substances					
	Lead (Pb)	Mercury (Hg)	Cadmium (Cd)	Chromium VI (Cr (VI))	Poly-brominated biphenyls (PBB)	Poly-brominated diphenyl ethers (PBDE)
Plastic	o	o	o	o	o	o
Hardware	o	o	o	o	-	-
Screw	o	o	o	x	-	-
Solder	x	o	o	o	-	-
PCB	x	o	o	o	o	o
IC	o	o	o	o	x	x
Glass	o	o	o	o	o	o

The symbol "-" indicates that the hazardous substance is not contained.

The symbol "o" indicates that the content of the hazardous substances in all the homogeneous materials of the component is below the limit requirement specified in the Standard IEC62321-2015.

The symbol "x" indicates that the content of the hazardous substance in at least one of the homogeneous materials of the part exceeds the limit requirement specified in the Standard IEC62321-2015.

## HDL Buspro Cable Guide

HDL Buspro	HDL Buspro Cable	CAT5/CAT5E
DATA+	Yellow	Blue/Green
DATA-	White	Blue white/Green white
COM	Black	Brown white/Orange white
24V DC	Red	Brown/Orange

#### Technical support

E-mail: [support@hdlautomation.com](mailto:support@hdlautomation.com)  
 Website: <https://www.hdlautomation.com>